

# Soho RACK

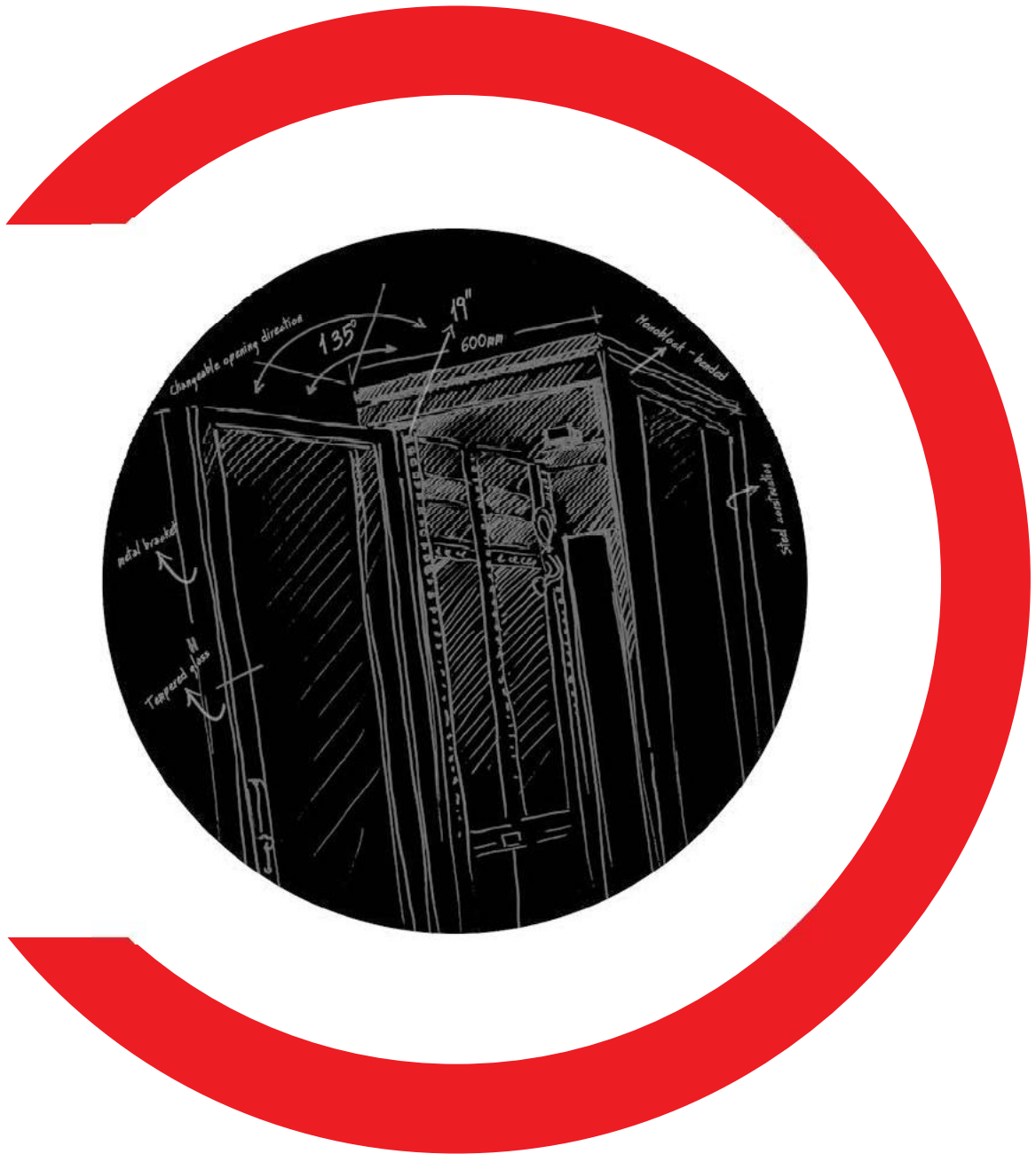



GÜNKO INDUSTRIAL

[www.gunko.com.tr](http://www.gunko.com.tr)

# INDUSTRIAL

*Günko Industrial, one of Gunok Group companies operating in the metal industry since 1974, was established in 2005.*

*Its modern technology according to an integrated infrastructure, experience and the needs of the IT world with dynamic staff presence of 19" indoor Racks and accessories, outdoor enclosures, server and data center cabinets.*

*All production processes are monitored and controlled by the ERP system.*

*Günko Industrial in the 19" rack industry in 2007 is the first enterprise engaged in the production of the EN standards, has been certified by TSE in 2010.*

*Its processes related to using the TS EN ISO 9001 Quality Management System and resources more effectively and efficiently control is continuous improvement.*

*Günko Industrial, within company boundaries, secure workspaces and safety work-related accidents by adopting a culture of prevention policies, to keep under control under the legal requirements and practices regarding enforcement of environmental legislation aims.*

*Günko Industrial pride of being the preferred brand comes from the excellent services offered to customers.*



elegant pro

server rack

elegant

net

open

GÜNKO

cabinets

rack

pro  
case

soho  
rack

accessories

fiber  
optic

elegant wall

Elegant Wall

Elegant pro

Elegant Net

cabinets

Server

Accessories

fiber optic

Soho

Open

Pro case rack

GÜNKO



*We are aware of our responsibilities as Gunko industrial.*

Elegant robust structure consist by front and rear welded frames.

19" Elegant Net & Elegant Pro rack cabinets are designed to meet the needs of high density network applications and it is engineered for superior weight capacity with welded construction.



% 100 Recyclable packaging Materials

**Elegant flat pack racks**  
less carbon footprint

**Green advantages of fat pack**

**Do not forget your environmental responsibility**

Compared to pre-assemble products flat pack rack cabinets is more environmentally conscious and it cuts down on size, which cuts down on shipping costs and also reduces the carbon footprint for a green Nature environment.



Elegant flat pack Rack cabinets enables consumers to assemble a product themselves with a manual instruction, saving significant amounts of money for the customers by reducing shipping and storage costs and for the consumers it offers an easier shape / size to carry.

**You can not change the structure of the buildings but you can order Flat pack Elegant rack ( all in 1 pack )**

Easy transportation for retail customers

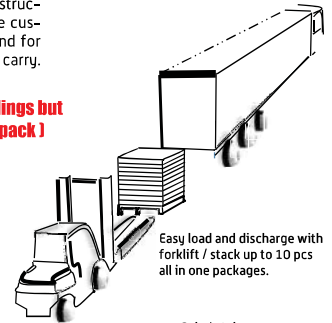

Easy load and discharge with forklift / stack up to 10 pcs all in one packages.

Door / Elevator



Thanks to Flat pack construction it is possible to bring them also into places with difficult access, e.g. basement or attic, narrow door-openings or spiral stairs.

Spiral stairs

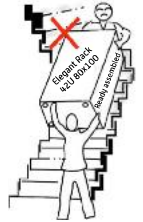

6

cabinets

[www.gunko.com.tr](http://www.gunko.com.tr)

GÜNKO

# Soho rack



soho rack cabinets

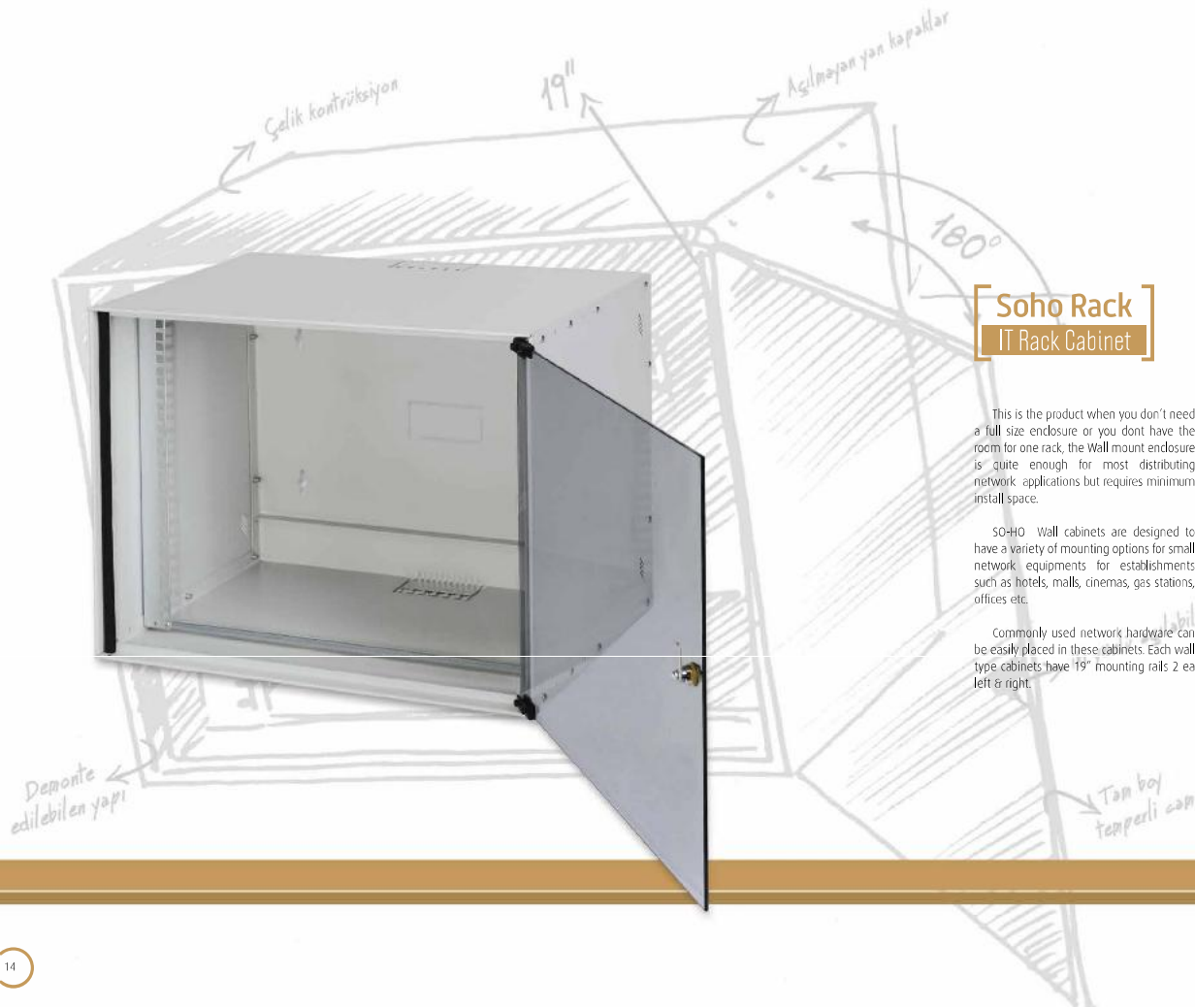

### Soho Rack IT Rack Cabinet

This is the product when you don't need a full size enclosure or you don't have the room for one rack, the Wall mount enclosure is quite enough for most distributing network applications but requires minimum install space.

SO-HO Wall cabinets are designed to have a variety of mounting options for small network equipments for establishments such as hotels, malls, cinemas, gas stations, offices etc.

Commonly used network hardware can be easily placed in these cabinets. Each wall type cabinets have 19" mounting rails 2 ea left & right.

SO-HO cabinets are compatible with all 19inch rack mount equipments and has enough depth for small size network equipment and network cables, size range is between 07U to 12U and the weight capacity up to 30g.

These racks ship fully assembled or flat pack with quick and easy assembly structure, this racks only front openable door for easy access for equipment during installation and maintenance, and all models are equipped with locking doors to prevent unauthorized access, the modular structure also providing extremely space efficient, saving significant amounts of money for the customers by reducing shipping and storage costs, in addition to this features.



**[ Soho Rack ]**  
IT Rack Cabinet

Cooling is an extremely important challenge in any networking situation

SOHO ventilation modules which can be detached by removing 4 pcs screws from the top in case of maintenance or replacement needs.

Protect your devices against overheating by choosing the right fan module.

We offer a wide product range of ventilation units with the different fan modules.

- On/Off switch Fan modules
- Analog & Digital Thermostat control Fan modules
- Rack mounting type 19inch Fan modules

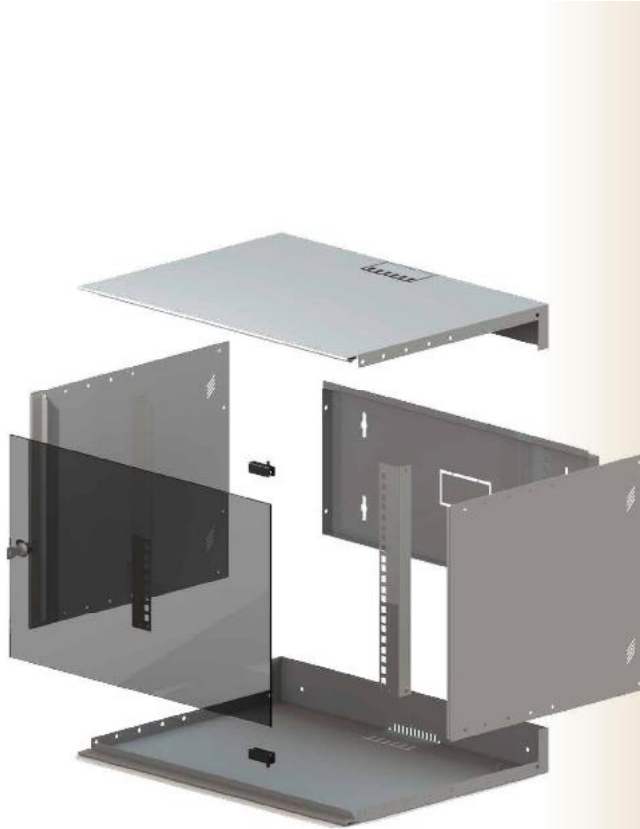

**Soho Rack**  
IT Rack Cabinet

**Doors and Panels of Soho Rack**

Front doors are easily removable with special hinge, single point locking mechanism, opening angle is 135°, opening direction is left from right. Also, its changeable opening directions with spring hinge. Front door are produced from 4mm tempered, antistatic full size glass.

Rear plate made from solid metal and fixed onto main body with screws. Also rear plate include pre-cut cable entry gap.

There are 4 hanging holes and it is used for template to drilling wall. Firstly, rear panel are fixed onto wall.

Secondly main body are fixed onto rear panel. With these user friendly assembling method, only one person could mount cabinets easily at installation area.



**10" Soho Cabinets**

There is only one solution as 5U 300x260mm 10" Soho cabinets. Top and bottom frames includes 2pcs 45x100mm cable entrance.

Front doors are easily removable with spring hinged, single point locking mechanism, opening angle is 135°, opening direction is left from right. Also, its changeable opening directions with spring hinge. Front door are produced from 4mm tempered, antistatic full size glass.

Rear plate made from solid metal and fixed onto main body with screws. Also rear plate include pre-cut cable entry gap.

There are 4 hanging holes and it is used for template to drilling wall.



Technical Drawing  
w: 530 mm d: 400 mm

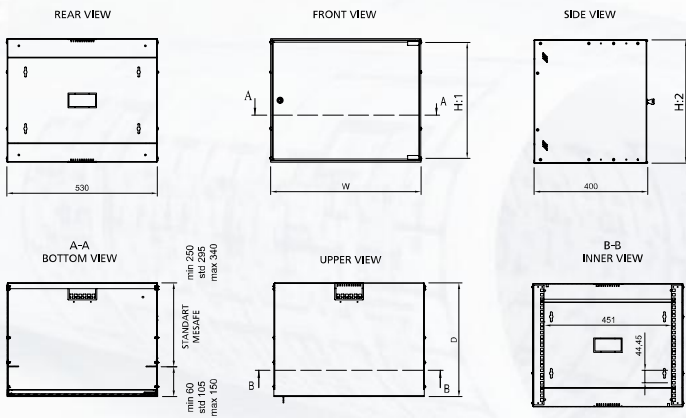

530 x 400 mm SOHO RACK

Product Code	Product Description	Out Width (W) (mm)	Out Depth (D) (mm)	Inner Height (H) (mm)	Out Height (H) (mm)
SHRK 04U 5340 CC III	Soho Rack 19" 4U W=530 mm D=400 mm	530	400	183	215
SHRK 07U 5340 CC III	Soho Rack 19" 7U W=530 mm D=400 mm	530	400	316	348
SHRK 09U 5340 CC III	Soho Rack 19" 9U W=530 mm D=400 mm	530	400	405	437
SHRK 12U 5340 CC III	Soho Rack 19" 12U W=530 mm D=400 mm	530	400	538	570
SHRK 05U 3026 CC III	Soho Rack 10" 5U W=300 mm D=260 mm	530	400	228	260

Standard finishing colour is RAL 7035-Light Grey. RAL 9005-Signal Black is optional.

# Soho rack



**Soho WIN**  
IT Rack Cabinet

SOHO WIN 19" wall mounting cabinets provide an aesthetic, functional and economic solution for cabling installations. SOHO WIN cabinets are designed to ensure the protection of all active and passive devices and contains additional functions to facilitate cable management with user friendly design and high tech production quality.

Solid and robust structure provide high load carrying capacity with slim design. At the same time ensuring user safety is our highest priority. SOHO WIN series cabinets can be used wherever 19" mounting space is needed like a hotels, schools, hospitals and offices.

Cabinets provide 2 parts 19" rack mounting area as 3U vertical +2U horizontal.

Top cover are easily openable, lockable with single point locking mechanism, opening angle is 180°. Also top cover includes plexiglass angled win-dow as optionally.

Main body made from pre-galvanized steel. It's include a lot of slots for passive ventilation and user friendly tie-wrap point for cable management.

The standard ventilation fan door is passive but could be use 80x80mm axial fan for forced ventilation.

Cabinets include 4pcs 5.8x100mm cable entry slots

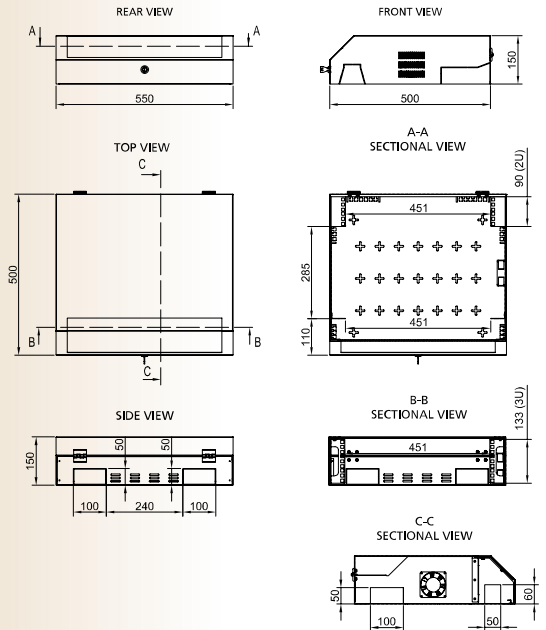

**3U SOHO WIN**

Product Code	Product Description	Out Width (W)(mm)	Out Depth (D) (mm)	Inner Height (H) (mm)	Weight (Kg)
GNK TT3ZSHK CC	Soho Win 19" 5U (3u Dikey, 2u Yatay)	550	500	150	10

Standard finishing colour is RAL 7035-Light Grey. RAL 9005-Signal Black is optional.